

USERS MANUAL

Desiccant Dehumidifier Model: ECO DD322FW CLASSIC

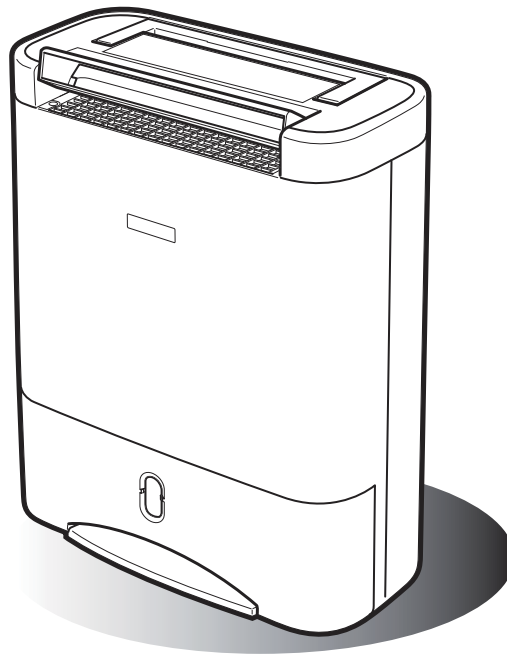

Read This Manual

Inside you will find many helpful hints on how to use and maintain your dehumidifier properly. Just a little preventative care on your part can save you a great deal of time and money over the life of your dehumidifier. You'll find many answers to common problems in the chart of troubleshooting tips. Review the chart of Troubleshooting Tips before calling your service engineers.

IMPORTANT SAFETY INSTRUCTIONS

PLEASE READ ALL INSTRUCTIONS CAREFULLY BEFORE OPERATING.

WARNING - This appliance is intended for use in a domestic environment only. Any other use is not recommended by the manufacturer and may cause fire, electrical shocks or other injury to person or property.

When using electrical appliances, basic safety precautions should always be followed:

1. Do not operate the unit with a damaged cord or plug, after it malfunctions or has been dropped or damaged in any way. Return to an authorized service facility for examination and repair.
2. This unit should always be kept in an upright position to avoid any damage. Locate the unit on a flat stable surface.
3. Check the household voltage to ensure it matches the units rated specification before operating.
4. Operate this unit in an ambient temperature between 1°C and 40°C.
5. Ensure that the air inlets and outlets are not blocked or covered.
6. Do not place the unit too close to curtains or other objects - min 40cm.
7. When using the "LAUNDRY MODE" to speed up the drying of wet clothes in the room, please keep the clothing at a safe distance from the unit to prevent water from dropping onto the unit.
8. Never place anything on top of the unit and do not cover with any kind of material while in use.
9. This product is intended for domestic and light office use ONLY and not for commercial, industrial or outdoor use.
10. To protect against electrical shocks, do not immerse unit, plug or cord in water, or spray with liquids.
11. Never unplug the power cord without press the "ON/OFF" key to off first, as this could damage the unit.
12. Always unplug the unit when not in use or moving location. To disconnect from the power supply, grip the plug and pull from the power socket. Never pull by the cord.
13. Always empty the water tank before storing the unit away.
14. Close supervision is necessary when any appliance is used by or near children and pets.
15. Do not run power cord under carpeting, or cover with rugs or runners. Arrange the cord away from areas where it may be tripped over.
16. Never operate or store the unit in direct sunlight.
17. To repair the unit, take it to a qualified service engineer. Repairs carried out by unqualified people may cause damage to the unit or injury to persons or property and void the warranty.
18. Where possible, avoid the use of an extension cable as they may overheat and cause a risk of fire. Only use an extension cord after ensuring it is in perfect condition.
19. Do not use the unit without the air filter.

This appliance is not intended for use by persons (including children) with reduced physical, sensory or mental capabilities, or lack of experience and knowledge, unless they have been given supervision or instruction concerning use of the appliance by a person responsible for their safety. Children should be supervised to ensure that they do not play with the appliance.

SAVE AND READ THESE IMPORTANT SAFETY INSTRUCTIONS

①

BS PLUG WIRING

Wiring Instructions: Should it be necessary to change the plug please note the wires in the mains lead are coloured in accordance with the following code:

BLUE - NEUTRAL
BROWN - LIVE
GREEN AND YELLOW - EARTH

As the colours of the wires in the mains lead of this appliance may not correspond with the coloured markings identifying the terminals in your plug, proceed as follows:

1. The **BLUE** wire is the **NEUTRAL** and must be connected to the terminal which is marked with the letter **N** or coloured **BLACK**.
2. The **BROWN** wire is the **LIVE** and must be connected to the terminal which is marked with the letter **L** or coloured **RED**.
3. The **GREEN/YELLOW** is the **EARTH** and must be connected to the terminal which is marked with the letter **E** or \oplus or coloured **GREEN OR GREEN/YELLOW**.
4. Always ensure that the cord grip is positioned and fastened correctly.

If a **13A (BS 1363)** fused plug is used it must be fitted with a **13A** fuse. If in doubt consult a qualified electrician.

Wiring for a 13 Amp Plug (BS1363)

Please note. The Earth Terminal is marked with the letter **E** or \oplus Earth Symbol.

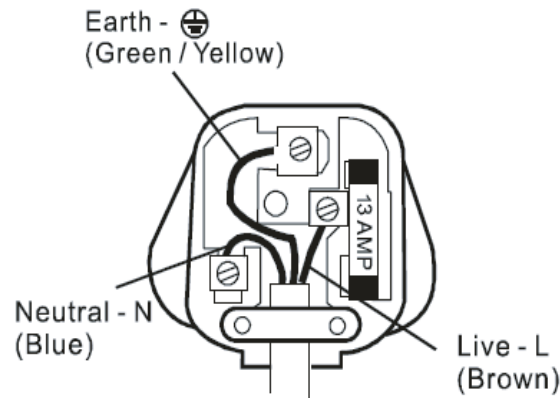

FEATURES

- **Compressorless dehumidifier** - uses desiccant rotor technology
- **Environmentally friendly** with no harmful gasses & quiet in operation
- **Moisture removal** - 10 litres/day (20°C RH60%)
- **Water tank capacity** - 3.5 litres
- **Electronic louvre**
- **Laundry mode** - includes power saving setting for summer use & turbo setting for winter
- **Up to 8 hour timer** - for added convenience
- **Temperature range for use** ~ 1°C - 40°C
- **Light & portable with carry handle**
- **Removable water bucket with handle**
- **Auto restart after power cut**
~ Once the power is restored after a power failure, the appliance will continue to operate at the selected settings prior to the power failure.

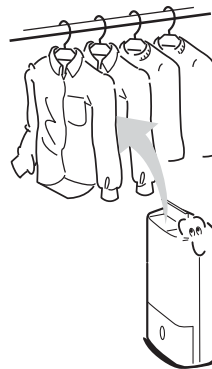
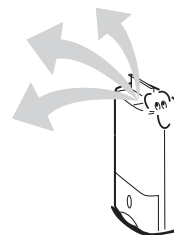

PRODUCT DESCRIPTION

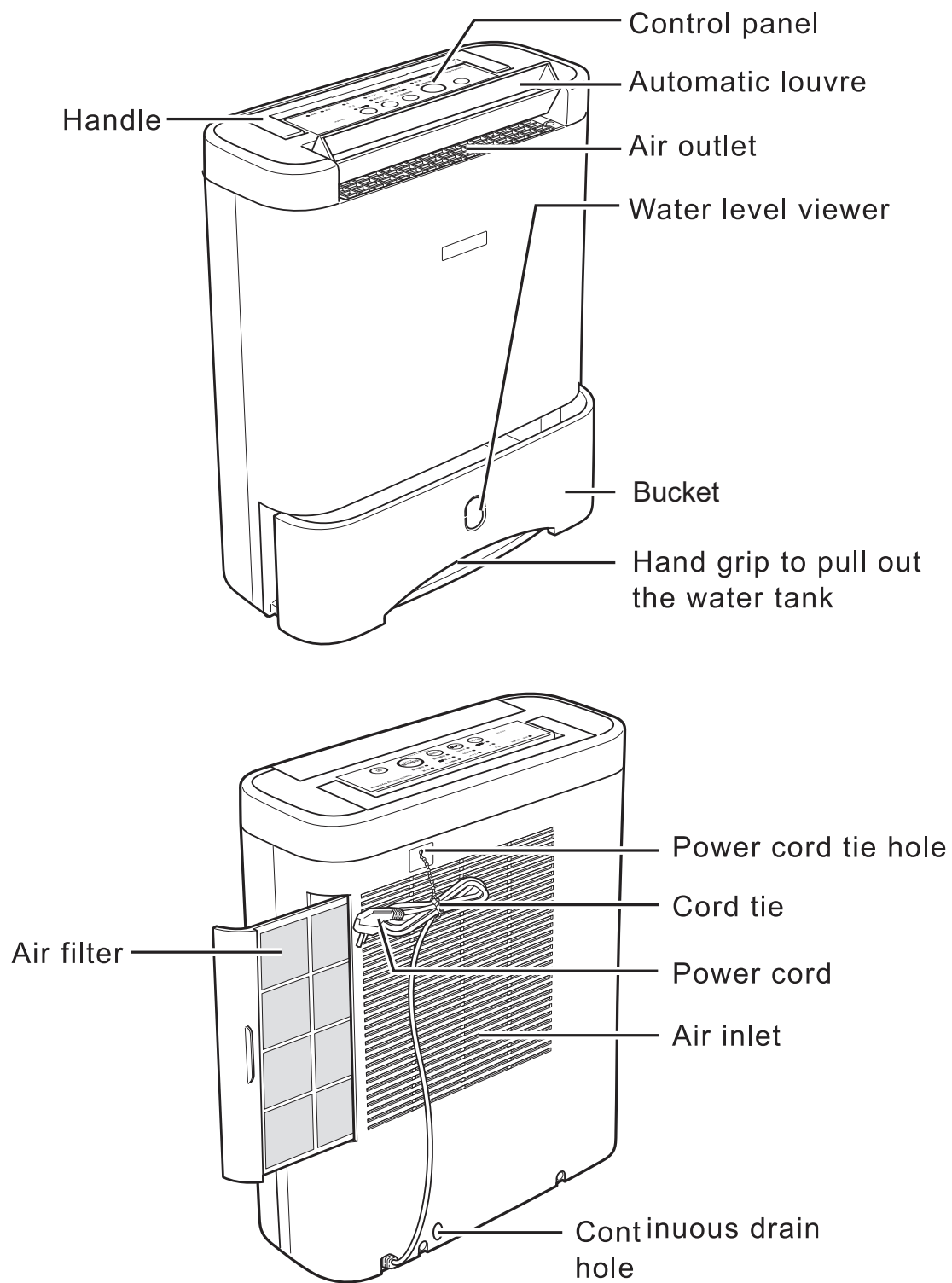

THE CONTROL PANEL

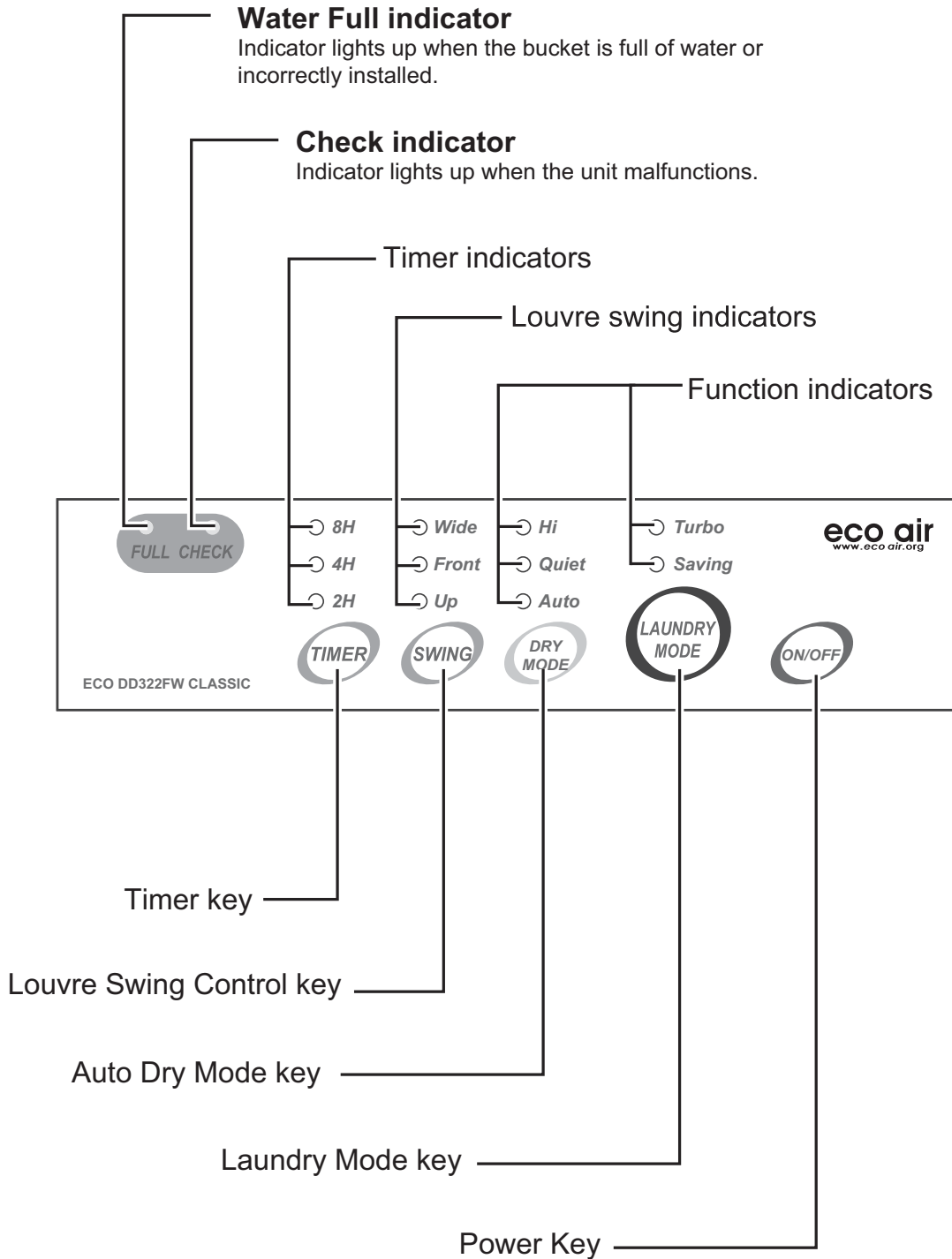

UNIT SETUP

- Place the unit in an upright position on a stable, level surface. (Please ensure unit is not sitting on its own cable)
- Please ensure the unit is a safe distance away from a wall or furniture (see the right graphic).
- Please keep clothes at a safe distance of 60 cm from air outlet of the unit to prevent water dripping into the unit.
- Where to position your dehumidifier?
For best results position the dehumidifier somewhere central like a landing or a hallway.
As long as the internal doors are open the excess moisture from all of the rooms in the house will migrate naturally towards the dehumidifier and be processed.

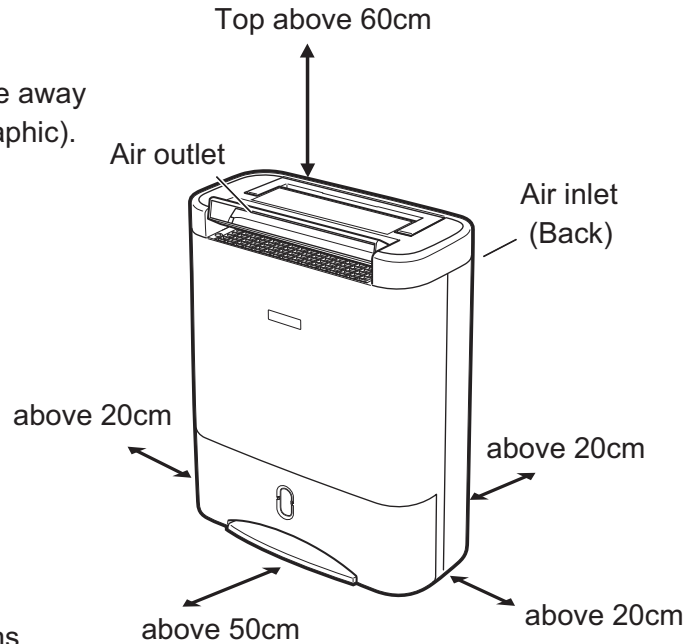

TO OPERATE SAFELY

- Do not insert small objects into the unit or this will damage it and cause a hazard.
- Do not attempt to remove bucket while unit is in operation to avoid water leakage.
- Keep suitable space as above
- Ensure bucket is fitted correctly.

OPERATING INSTRUCTIONS

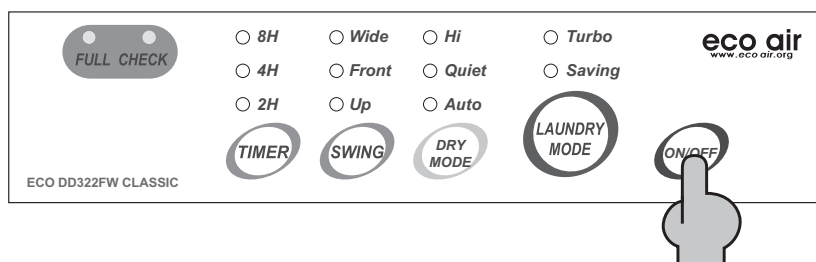

■ ON and OFF

Connect the power plug to the appropriate electrical socket outlet.

Press the ON/OFF button to turn the appliance ON.

Press the ON/OFF button again to turn the appliance OFF.

Note: In the event of a power failure

Once the power is restored after a power failure, the appliance will continue to operate at the selected settings prior to the power failure.

This includes the drying mode, swing function and time remaining in timer mode.

Note: After turning the appliance OFF

After turning the appliance OFF using the ON/OFF button, the fan will continue to run for a two minute period. This is a normal procedure and helps to cool & protect the internal components.

During this two minutes DO NOT remove the power plug from the electrical socket outlet; wait for the fan to stop running.

OPERATING INSTRUCTIONS

■ DRY MODE

- Press the "DRY MODE" Key for automatic dehumidification.

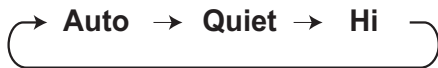

MODE	DESCRIPTION
Auto	To keep the room at a comfortable Relative Humidity (RH) level <ul style="list-style-type: none">● The unit automatically keeps room humidity at 45~50% RH.● The fan speed & heater power are adjusted automatically.
Quiet	To run low fan speed <p>The unit automatically dehumidifies in low fan speed and</p> <ul style="list-style-type: none">● low noise.
Hi	Super dry mode to prevent dew <ul style="list-style-type: none">● The unit automatically keeps room humidity at 35~40% RH to prevent dew in the room.

Note: There may be no difference between **Auto** and **Quiet** fan Speeds.

Auto itself is not a fan speed but a target relative humidity set point that uses either the low or high fan speeds to reach it's target of 45-50%RH.

If the relative humidity of the room is close to or within this range then switching between **Auto** and **Quiet** will make no difference to the fan speed.

■ LAUNDRY MODE

- Press the "LAUNDRY MODE" key for drying clothes.

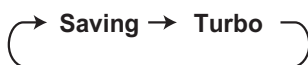



MODE	DESCRIPTION
Saving	Suitable for summer to save power <ul style="list-style-type: none">● The unit automatically provides warm dry air to assist in clothes drying with low power.
Turbo	Suitable in winter to dry clothes faster <ul style="list-style-type: none">● The unit automatically provides heat air to dry clothes faster with higher power.

OPERATING INSTRUCTIONS

AUTO SWING LOUVRE

- Press the "SWING" Key to select air louvre angle.

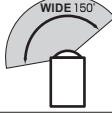

MODE	DESCRIPTION
Up	<ul style="list-style-type: none">• The automatic louvre swings in an upward range of approx 100° 
Front	<ul style="list-style-type: none">• The automatic louvre swings in a front range of approx 50° 
Wide	<ul style="list-style-type: none">• The automatic louvre swing in a wide range of approx 150° 
Hold	<ul style="list-style-type: none">• The automatic louvre stops swinging when you press "SWING" key and turns the LED off.

TIMER MODE

- Press the "TIMER" Key to select your desired running time (2,4 or 8 hours).
The unit will automatically switch off at the end of the selected time period.
As the time counts down the LED (4 or 2 hours) lights will indicate the time remaining.
- When no "TIMER" is set (the LED is off), the unit will run continuously, unless the bucket is already full.

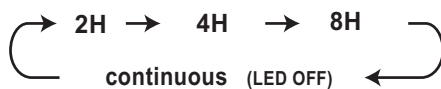

PLEASE NOTE

■ Smell coming from the dehumidifier

When you first use the dehumidifier and periodically afterwards you might notice a smell coming from the dehumidifier. This is caused by the Zeolite desiccant material and is not a sign that the dehumidifier is faulty, nor is it harmful to humans or pets. The smell occurs because the Zeolite absorbs odours from items like cigarettes, cosmetics, hair sprays, building materials and new furniture and then when the desiccant is heated the smell is discharged into the room. This smell has been described as being like a burning smell or a sour smell. It is normal, will not last long and is not a sign of a fault.

■ Amount of water collected

When you first use your dehumidifier it will work harder to reduce the room humidity to its target of 45-50%RH, this is the time when it will produce the most water and need emptying most frequently. As the room becomes dryer the dehumidifier collects less water and runs at a lower fan speed. This is normal. When the target relative humidity has been reached the air coming out of the dehumidifier will not be heated and it will only be running in low fan mode. This is because there is no need for dehumidification at this point and the dehumidifier is sampling the air to check the current relative humidity to see if dehumidification is required.

If you find that you still have condensation on your windows or you need to dry the air further then using the High fan speed, or the Turbo Laundry mode, will force the dehumidifier to dry the air further to 40%RH. This might well be necessary if you have single glazed windows or if the outside air temperature drops to freezing.

TO EMPTY THE BUCKET

1. When the bucket is full, the FULL LED lights up and the unit stops.
2. Do not move the unit or remove the bucket, if the machine is still operating, as water may leak, damage the unit or cause an electric shock.
3. To remove the bucket, pull it out by gripping the bottom of the bucket, and lift carefully.
4. Remove the cover of bucket first, then pour the water away, clean the bucket and restore the cover and the bucket to the correct position.

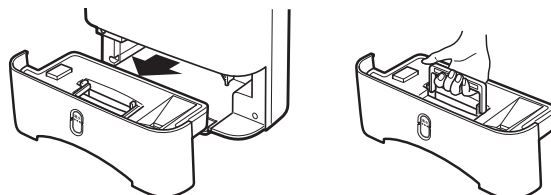

A Pull bucket out

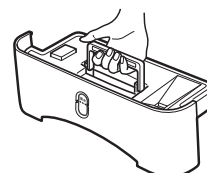

B Lift by the handle

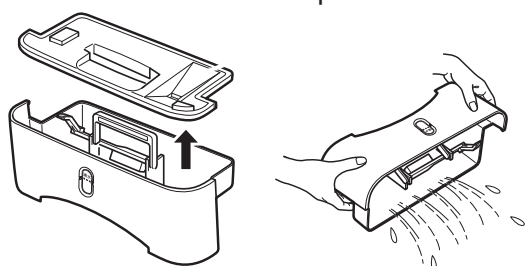

C Remove the cover

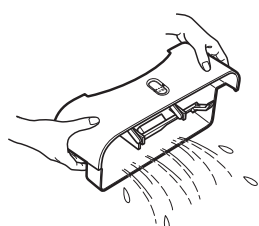

D Pour the water contents

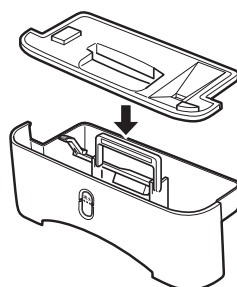

E Refit the cover

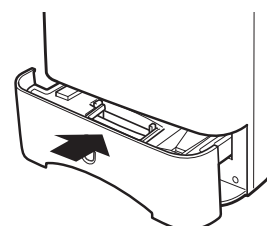

F Restore the bucket

NOTE:

- Clean the bucket with clean water if needed. Do not use detergent, solvent, abrasive or hot water to avoid damage to the appliance.
- Do not remove or damage the float in the bucket, the unit will not work correctly.
- The bucket cover must be well fitted in position.
- The "FULL" LED lights if the bucket is not well in place.

PERMANENT DRAIN OPTION

A hose with an inner diameter of 12mm can be connected for continuous drainage.

1. Remove the bucket.
2. There is a through hole at the lower left corner on the back of the appliance.
3. Pass the hose through the hole.
4. Remove the plug from the drain hole at the back of the bucket. **Keep it safely for future use.**
5. Push and connect the hose firmly to the drain hole of the bucket.
6. Restore the bucket in the correct position.

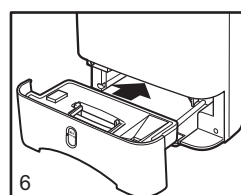
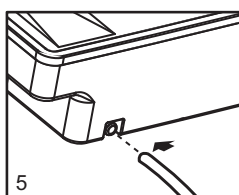
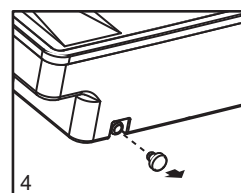
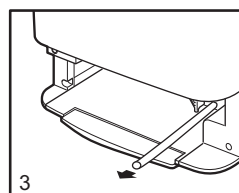
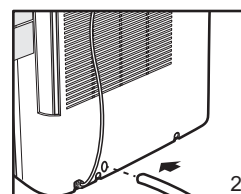
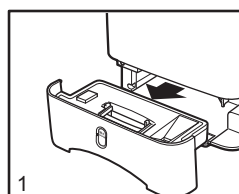

MAINTENANCE

Cleaning the unit

1. Turn the appliance OFF, wait for the fan to stop and ensure the plug is removed from the socket outlet.
2. Clean the casing using a soft damp cloth with warm water and mild detergent.
Do not use solvents or abrasive materials.
3. Use a soft dry cloth to wipe the casing dry.
4. To avoid damage to internal parts, do not let water to drip into the air inlet or outlet and do not wash the machine with water.

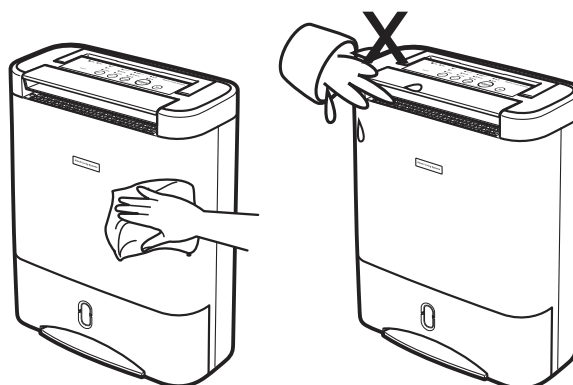

Cleaning the filter

If the filter is covered by plenty of dust, the airflow and performance of the unit will be affected and malfunction may occur. It is recommended to check and clean the filter every two weeks.

1. Turn the appliance OFF and ensure the plug is removed from the socket outlet.
2. Remove the filter located at the back of the appliance.
3. Clean the filter using clean water and dry it before use, or alternatively clean using a vacuum cleaner.
4. Restore the filter into the appliance.
5. Never run the unit without the filter.

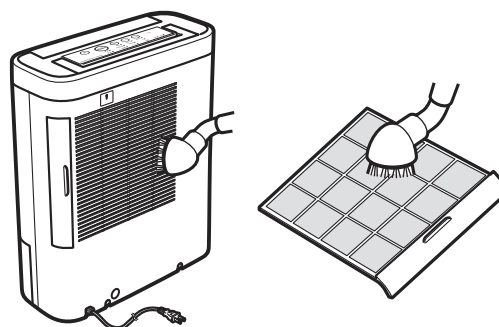

Before storing

1. Turn off the unit, wait for it to stop and unplug from the power socket.
2. Clean and dry the bucket. Leave the unit to drain for approximately one day.
3. Clean the filter and the unit. Cover the unit to prevent it from gathering dust. Store upright in a cool dry place.
4. Do not expose to direct sunlight.

TROUBLESHOOTING

The following conditions are normal:

1. The fan is still running about 2 minutes after turning off the the unit.
2. The unit works within room temperature about 1~40°C. It may stop operation out of this range or when the air inlet or outlet is covered. (The "CHECK" LED light will illuminate)
3. The unit includes heater function that could increase the room temperature.

If your Dehumidifier stops working or "CHECK" LED illuminates, please check the following items first.

Problem	Possible Causes	What to Do
Dehumidifier doesn't start (no lamp)	The unit is unplugged	Make sure the plug is pushed completely into the outlet.
	The fuse is blown or circuit breaker is tripped	Check the house fuse / circuit breaker box and replace fuse or reset the breaker.
	The unit falls down or is not level on the floor / surface	Place the unit on a stable, level surface.
Water Less	The room humidity has reached the setting	It uis normal, you may choose Hi or Turbo mode if you need a drier humidity level.
	The ambient temperature is too high, such as over 40°C	Do not use it in a small and closed place where heat accumulates. Move to a cooler place, wait at least 10 minutes to resume operation.
FULL lamp lights	The bucket is full or not in place	Empty the bucket, check the float in position, and replace the bucket.
CHECK lamp lights	The air inlet or outlet is covered / blocked	Make sure there is nothing blocking the air inlet and air outlet of the unit. Clean the filter. Unplug and wait at least 10 minutes to resume operation.
	Filter clogged with dust	
Water on floor	The unit is not level	Check the unit is placed on a level surface and not accidentally sitting on a cable etc.
	The drainage is clogged or loose	Check the drainage hose and its connection.

NOTE:

1. If the "CHECK" LED illuminates, turn off the unit, unplug from the power socket, check and clean the filter. If it is dirty, remove any obstacle that covers the air inlet or outlet, and wait for at least ten minutes before plugging in and switching back on.
2. Please contact your retailer if the problem continues.

Do not try to repair it yourself, as this could cause an electrical shock and void your warranty.

SPECIFICATIONS

Model: ECO DD322FW CLASSIC

Operating Temperature Range: 1°C - 40°C

Dehumidifier extraction Rate: 10 Litres/Day(20°C, 60%RH)

Bucket Capacity: 3.5 Litres

Power: High: 740W / Low:440W

Voltage: 220-240V ~ /50Hz

Net Weight: 7.8Kg

Dimensions: Width 416 x Depth 186 x Height 520 (mm)

SERVICE AND WARRANTY

ONE (1) YEAR LIMITED WARRANTY Save This Warranty Information

EcoAir guarantees this product free from defects in materials and workmanship for a period of one (1) year from the date of purchase. Coverage is valid only with proof of purchase.

This unit must be operated under conditions as recommended, at voltages indicated on the unit. Any attempts made to service or modify the unit, will render this **WARRANTY VOID**. The actual product may differ slightly from the illustration. This warranty is in addition to, and does not affect, your statutory rights.

For further information, please contact 020 8459 2458.

This product has been manufactured to comply with the EC Directives 2006/95/EC and 2004/108/EC.

We recommend that you note the details of your purchase below and retain your original proof of purchase receipt with this manual. Keep these documents safe in the event of a warranty claim.

Date of purchase: _____

Retailer name: _____

Serial number: _____

eco air
www.eco air.org

CE 
Copyright Reserved